

# IN5100 (SERIES)

# InFocus

Bright Ideas Made Brilliant

## Capture a larger audience

The InFocus IN5100 series of digital projectors offer 4000-5000 lumens, XGA, SXGA+, and WXGA resolution options, and simplified installation and integration. These projectors feature optional lenses and horizontal/vertical lens shift to power images big enough for even the largest venues.

The administrator-friendly IN5100 series offers an embedded diagnostic & control utility to monitor & alert users of projector status and function controls.

## Installation Features

### Interchangeable Lenses

The IN5100 series features interchangeable lenses to easily fit ultra short-throw rear projection or long-throw installation needs:

#### Fixed Short Throw Projection Lens (LENS-037)

Zoom Ratio 1.0:1  
Throw Ratio 0.8:1  
F No. 2.3

#### Short Throw Projection Lens (LENS-038)

Zoom Ratio 1.6:1  
Throw Ratio 1.2 ~ 2.0:1  
F No. 1.94 ~ 2.55

#### Long Throw Projection Lens (LENS-039)

Zoom Ratio 1.2:1  
Throw Ratio 1.9 ~ 3.9:1  
F No. 2.10 ~ 2.92

#### Ultra Long Throw Projection Lens (LENS-040)

Zoom Ratio 1.85:1  
Throw Ratio 3.9 ~ 7.4:1  
F No. 2.24 ~ 3.10

## Presentation Flexibility

### Bright Single-Lamp Design

The IN5106 achieves a rating of 5000 lumens with only one lamp, making this advanced projector both powerful and economical.

### Wireless Ready

Eliminate cables and speed set-up time with LiteShow III™. This wireless adapter enables cable-free presentations. Switch presenters in seconds and transmit data, audio and stunning video over a 91 m range.

### Change Lamps Easily

Replacing lamps is easy thanks to the ceiling-accessible lamp door.

### Assignable Audio Inputs

The IN5100 series allows you to select an audio input to assign to each computer or video input for the ultimate installation flexibility.

### A Wide Variety of Connections

With 5 BNC, HDMI 1.3, VGA, RS-232, networking, and component video all available, the InFocus IN5100 series features advanced connectivity and flexibility to tailor your presentations to your venue or audience.

### SplitScreen™ Technology

The IN5104 features SplitScreen technology, making it possible to project from two sources side by side on the same screen. By allowing presentation sharing and multiple user input, you're able to create a collaborative big picture experience.



#### MODELS

##### IN5102

XGA  
(1024 × 768)  
4000 lumens

##### IN5104

WXGA  
(1280 × 800)  
4000 lumens

##### IN5106

XGA  
(1024 × 768)  
5000 lumens

##### IN5108

SXGA+  
(1400 × 1050)  
4000 lumens



### Comprehensive connectivity options for ultimate flexibility

S-Video	5 BNC (RGBHV/YPbPr)
Composite Video	Wired Remote
D-Sub HD15	HDMI 1.3
Component Video	

## Why you should choose the IN5100 Series

- Brightness up to 5000 Lumens for large venues
- Embedded diagnostic and control utilities for improved administration
- Widescreen and SplitScreen model available for collaboration, education or anywhere you need to show more than one source simultaneously
- SXGA+ resolution for optimal clarity and the finest details
- Horizontal and vertical lens shift with four optional lenses for versatility
- Top accessible lamp door for ease of maintenance
- Assignable audio inputs for installation flexibility
- Optional LiteShow III wireless adapter enables cable-free presentations over a 299-foot range

# IN5100 (SERIES)

## Intuitive and Easy to Use Interface

Over 20 years of customer feedback has gone into designing the IN5100 series best-in-class menu system. It is easy to navigate, has 17 standard languages and a unique intuitive flow.

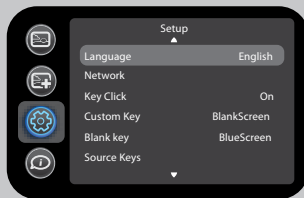

## Optional Accessories

Replacement Lamp IN5102/IN5106 (SP-LAMP-038)  
 Replacement Lamp IN5104/IN5108 (SP-LAMP-046)  
 LiteShow III Wireless Adapter (INLITESHOW3)  
 Universal Ceiling Mount (SP-CEIL-UNIV)  
 Mount for LiteShow III (INLITESHOW-MOUNT)  
 Cables & Adapters



LiteShow III

For more information, please visit:  
[www.infocus.com/Accessories.aspx](http://www.infocus.com/Accessories.aspx)

## Warranty

Providing the highest quality products and support is very important to InFocus. The IN5100 series of digital projectors comes standard with a 2 year limited factory warranty (including parts and labor) and a 6 month limited lamp-replacement warranty. Extended product and lamp warranty programs are also available.

For more information, please visit:  
[www.infocus.com/Support/Warranty.aspx](http://www.infocus.com/Support/Warranty.aspx)



# InFocus

Bright Ideas Made Brilliant

[www.infocus.com](http://www.infocus.com)

**INFOCUS CORPORATE HEADQUARTERS**  
 13190 SW 68th Parkway  
 Portland, Oregon 97223-8368, USA  
 Phone: (1) 503-207-4700  
 Toll Free: (1) 877-388-8385  
 Fax: (1) 503-207-1937

**INTERNATIONAL HEADQUARTERS**  
 4 Teck Lim Road  
 Singapore 088382  
 Phone: (65) 6513-9600  
 Fax: (65) 6238-0535

# Specifications\*

IN5102 IN5104 IN5106 IN5108

Native Resolution	<b>IN5102/IN5106</b> – XGA 1024 × 768 <b>IN5104</b> – WXGA 1280 × 800 <b>IN5108</b> – SXGA+ 1400 × 1050
Maximum Resolution	UXGA 1600 × 1200
Display Technology	<b>IN5102/IN5104</b> – .8" P.S.I TFT LCD × 3 <b>IN5106/IN5108</b> – .8" P.S.I TFT LCD × 3 MLA (Micro Lens Array)
Brightness	<b>IN5102/IN5104/IN5108</b> – 4000 ANSI lm (3200 lm Eco Mode) <b>IN5106</b> – 5000 ANSI lm (4000 lm Eco Mode)
Lamp Life**	3000 Hrs Eco Mode (2000 Hrs Normal)
Contrast Ratio	1000:1 with Active Iris
Audible Noise	30 dBA Eco Mode (32 dBA Normal)
Computer Compatibility	PC, MAC
Throw Ratio	1.5 ~ 1.8:1 (distance/image width)
Zoom Ratio	1.2:1
Projection Methods	Front, rear, ceiling front, ceiling rear
Projection Distance	3.75 ft ~ 43.75 ft / 1.1 m ~ 13.3 m Standard Lens
Number of Colors	16.7 Million, True Colors
Digital Keystone Correction	Vertical -40 / +40 degrees, Horizontal -20 / +20 degrees, Vertical Correction -5 / +15 degrees; video / data
Aspect Ratio	<b>IN5102/IN5105/IN5108</b> – 4:3 (native), 5:4, 16:9, 16:10 <b>IN5104</b> – 16:10 (native), 4:3, 5:4, 16:9
Lamp Power	220 W Eco Mode (275 W Normal)
Synch - Horizontal Scan Freq - Vertical Scan Freq	15 ~ 91 kHz (Video/PC) 50 ~ 120 Hz (Video/PC)
Video Compatibility	SDTV / NTSC / PAL and SECAM (480i/576i), EDTV (480p/576p), HDTV (720p/1080i/1080p)
Input Sources	VGA (Component to VGA adapter available), 5 × BNC (RGBHV / YPbPr), S-Video, 2 × 3.5 mm Stereo Jacks, HDMI 1.3 (w/audio), Component Composite Video, 2 × RCA Stereo Jacks
Control	Projector Keypad, IR Remote Control, USB, RS232, RJ45, Wired Remote
Product Weight	15.7 lbs / 7.1 kg
Product Dimensions - W×D×H	16.5 × 12.4 × 5.1 in / 420 × 314 × 129 mm
Product Color	Black with Silver
Shipping Dimensions - W×D×H	21.6 × 18.5 × 9.2 in / 549 × 469 × 233 mm
Shipping Weight	23.2 lbs / 10.5 kg
Maximum Altitude	7,500 ft / 2286 m
Ships with - Accessories	Power Cord, RGB Cable, AV Cable, Safety Instructions, User Manual, Remote
Menu Languages	English, French, German, Italian, Korean, Norwegian, Portuguese, Russian, Simplified Chinese, Spanish, Swedish, Traditional Chinese, Dutch, Polish, Turkish, Danish, Finnish
Lamp Rupture Containment	Tested to larger than 0.8 mm ***
Accessories Warranty	90 days
Approvals	UL and c-UL (US/Canada), FCC (US/Canada), GOST (Russia), CE (Europe), TUV GS (Germany), CCC (China), IRAM (Argentina), NOM (Mexico), PSB (Singapore), RoHS

\* Product specifications, terms, and offerings are subject to change at any time without notice.

\*\* Actual lamp life may vary based on the ambient environment and projector usage. Conditions that may affect lamp life include temperature, altitude, and rapidly switching the projector on and off.

\*\*\* Tested to contain particles larger than the specified size in any dimension

LiteShow III™ wireless ready

Split Screen™ HDMI™  
PROHIBITION FOR MULTIMEDIA INTERFACE

©2011 InFocus Corporation. All rights reserved. Specifications are subject to change without further notice. InFocus and InFocus Bright Ideas Made Brilliant are either trademarks or registered trademarks of InFocus Corporation in the United States and other countries. All trademarks are used with permission or are for identification purposes only and are the property of their respective companies.  
 InFocus\_IN5100\_EN\_14APR11. Part Number: MMINFOCUS-0204.