

# **INSTALLATION INSTRUCTIONS**

Outdoor Dual-Sided Floor-Mounted Displays

# Pre-Installation Precautions and Safety Guidelines for Outdoor Single-Sided Floor-Mounted Display Installation

## 1. Safety Precautions:

### Professional Installation:

- Installation of outdoor displays must be performed by qualified and experienced installation personnel.
- Ensure installation personnel are familiar with electrical safety, structural mechanics, and outdoor installation standards.

### Power Disconnection:

- Before performing any installation or maintenance work, always disconnect the power supply and confirm that the power is completely off.
- Use professional electrical testing tools to ensure there is no residual current in the circuit.

### Personal Protective Equipment (PPE):

- Installation personnel must wear necessary PPE, including safety helmets, safety shoes, insulated gloves, and safety harnesses.

### Working at Heights:

- If working at heights is required, use safety-standard-compliant lifting equipment or scaffolding.
- Ensure the stability of the lifting equipment or scaffolding and set up safety warning lines.

### Heavy Object Handling:

- Outdoor displays are typically heavy, and professional lifting equipment or coordinated multi-person operation must be used during transport.
- Ensure that collisions and tipping are avoided during transport.

### Weather Conditions:

- Avoid installation in adverse weather conditions (such as thunderstorms or strong winds).
- In the event of sudden weather changes, immediately stop installation work and take safety measures.

### Electrical Safety:

- Ensure all electrical connections comply with local electrical safety standards.
- Use waterproof connectors and cables to ensure the reliability of electrical connections.
- Check that grounding is adequate.

## 2. Pre-Installation Precautions:

### Site Survey:

- Before installation, a detailed site survey must be conducted, including ground flatness, load-bearing capacity, power supply location, network cabling, etc.
- Ensure the installation location meets the display's size and weight requirements.

### Installation Plan:

- Based on the site survey results, develop a detailed installation plan, including installation steps, required tools, and materials.
- The installation plan should be reviewed by professional personnel.

### Foundation Preparation:

- Prepare the installation foundation according to the display's installation requirements, such as embedded parts and anchor bolts.
- Ensure the strength and stability of the installation foundation.

### Equipment Inspection:

- Before installation, conduct a comprehensive inspection of the display, including appearance, electrical performance, and display effect.
- Ensure the display is free of damage or defects.

### Tool Preparation:

- Prepare all tools required for installation and check that the tools are in good condition.

### Read the Installation Manual:

- Carefully read the manufacturer's installation manual and familiarize yourself with the installation steps and precautions.

## 3. Environmental Precautions:

### Ventilation:

- Ensure the display installation location is well-ventilated.

### Waterproofing:

- Ensure all wiring and interfaces are waterproofed.

## 4. Legal Regulations:

- Ensure installation complies with local building codes and safety regulations.
- When installing in public places, it may be necessary to obtain permits from relevant departments.

## 1.Embedded screws and cables.

Pre-embed M12 / M16 bolts  
with a height of 50~60mm

Power cord and network cable  
reserve 2 meters

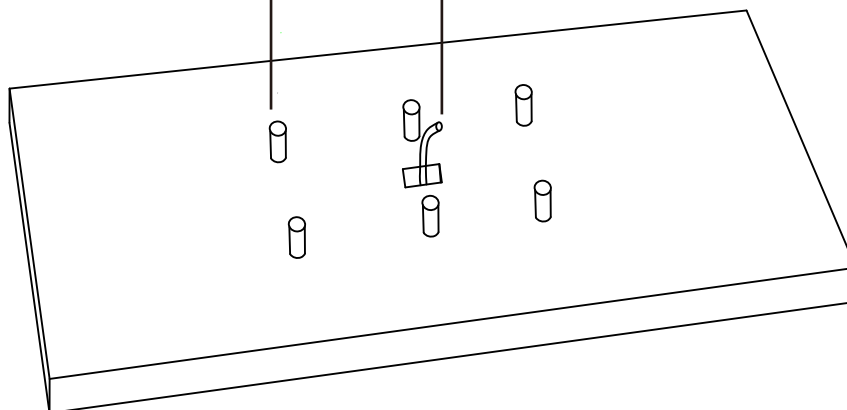

## 2.Open the door.

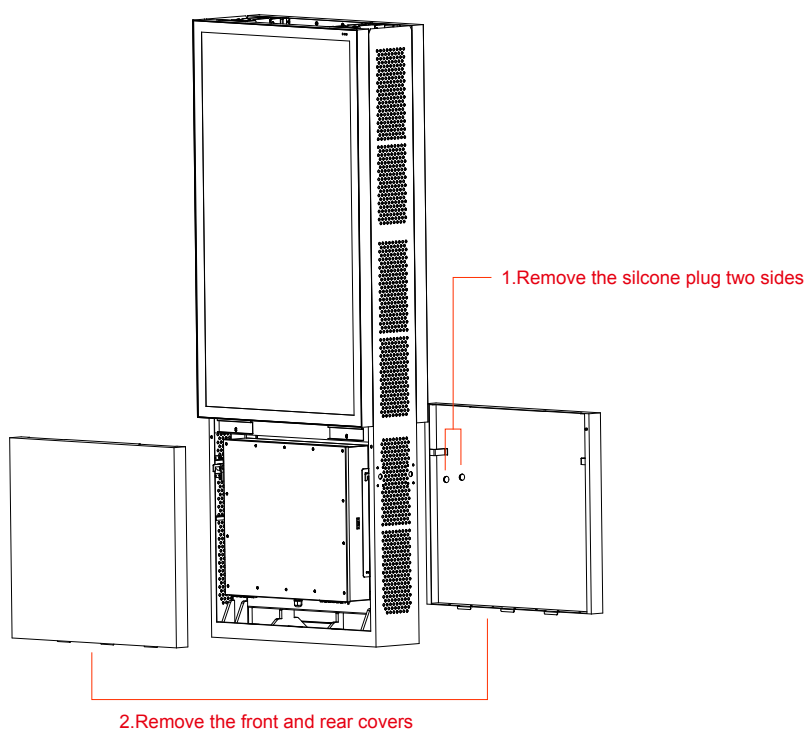

### 3.Remove the E-box and install the eyebolts.

Temporarily remove the E-Box to provide more space for nut installation.

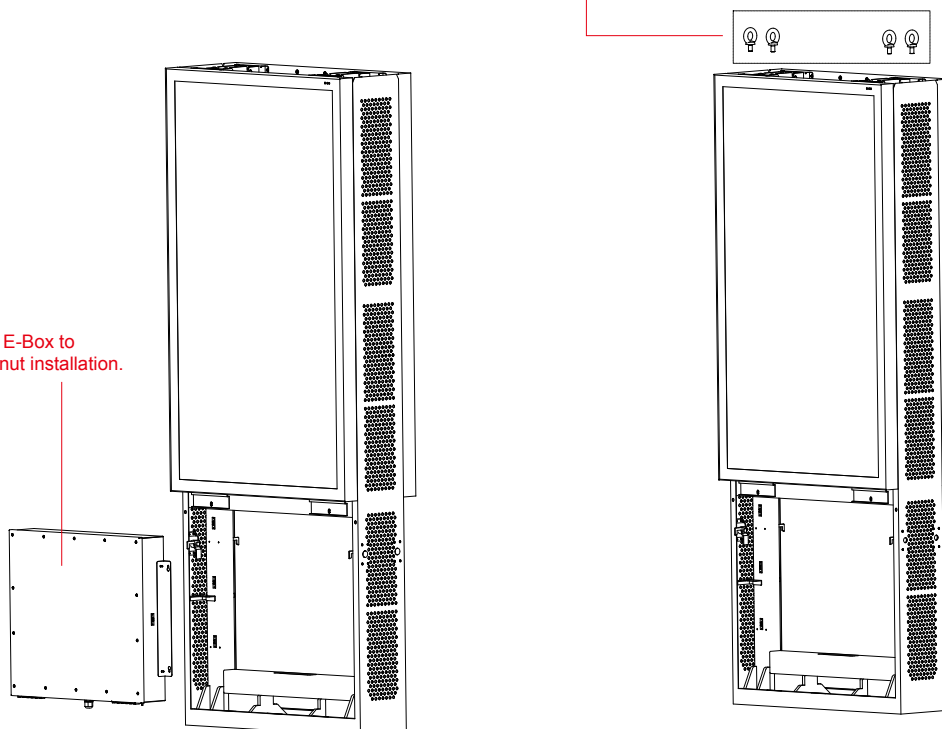

### 4.Install the whole machine.

#### Lift the product:

Use a forklift to protect and lift the product as shown in the diagram, then move it to the installation point, ensuring both the product and personnel are well-protected.

Operate the forklift safely with trained personnel, and protect the product using padding, straps, or foam as instructed.

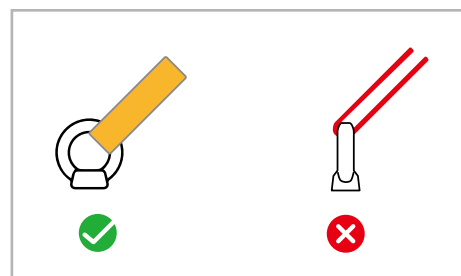
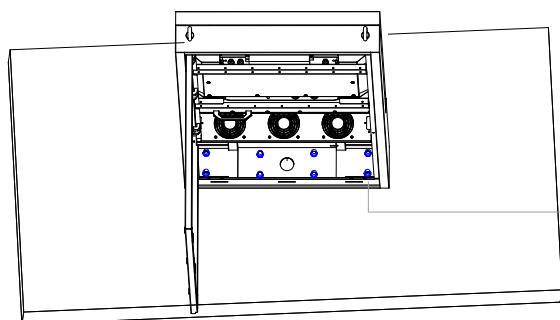

Place the kisok on the foundation,  
Use nuts corresponding to M12/M16 bolts for fixation,  
ensuring proper tightening.

## 5. Return the E-Box to its original location.

Install the E-box.

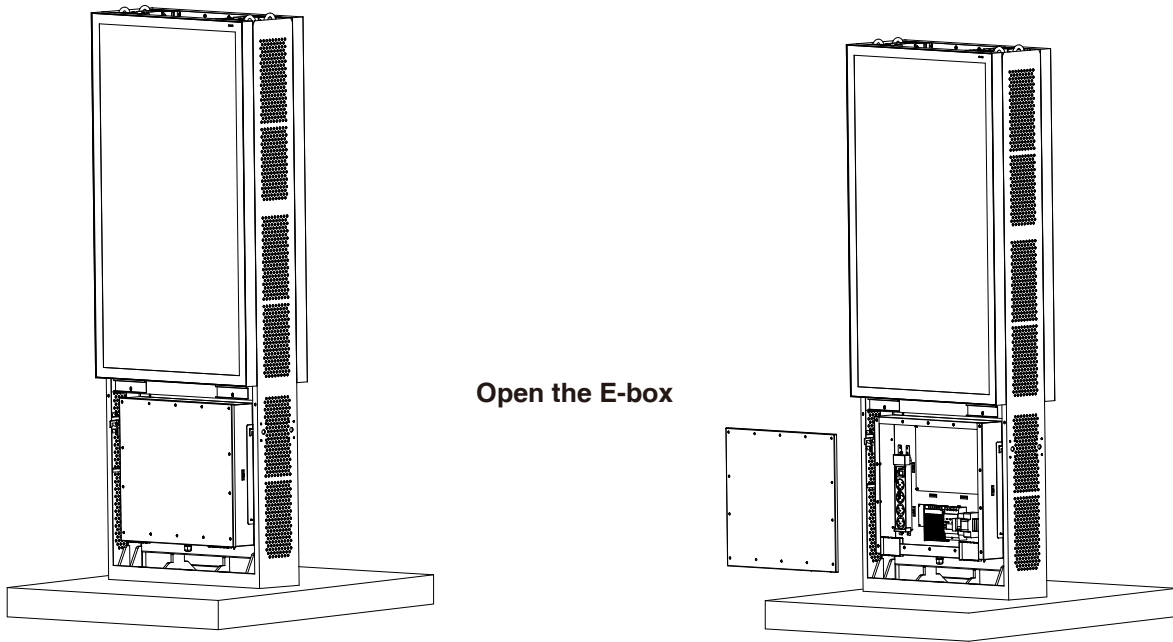

## 6. Connect the power cable and network cable

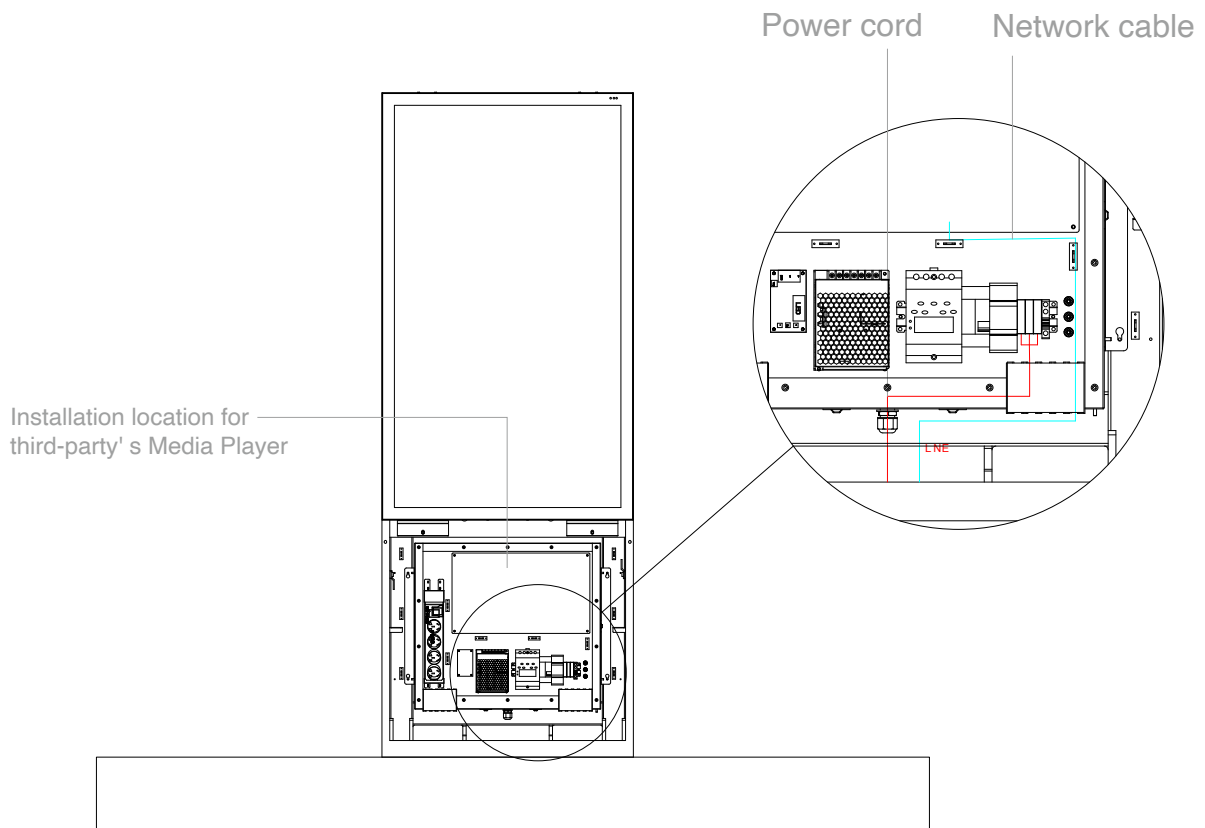

## 7.Final Assembly

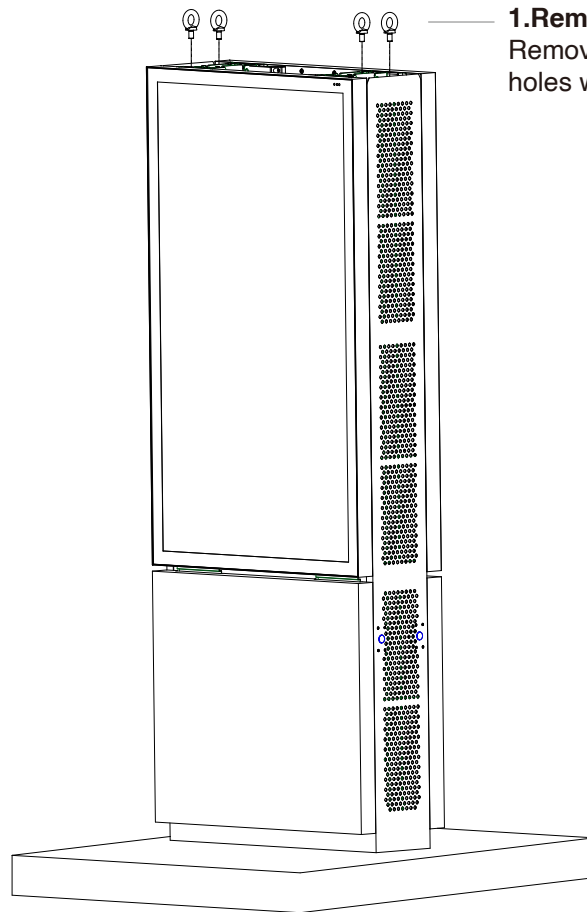

### 1.Remove the eyebolts:

Remove the top lifting rings and seal the holes with the provided sealing caps.

Please do not hesitate to contact our customer support department if you

encounter any difficulties. Our engineers will be in touch with you in no time. Address:

Suite 605-601 , No.22 , Lane 118 , Zhong Jiang Road , Hai Liang Plaza, Shanghai , 200062, China

Tel: 86-021-54049988 ext 172 or 173